

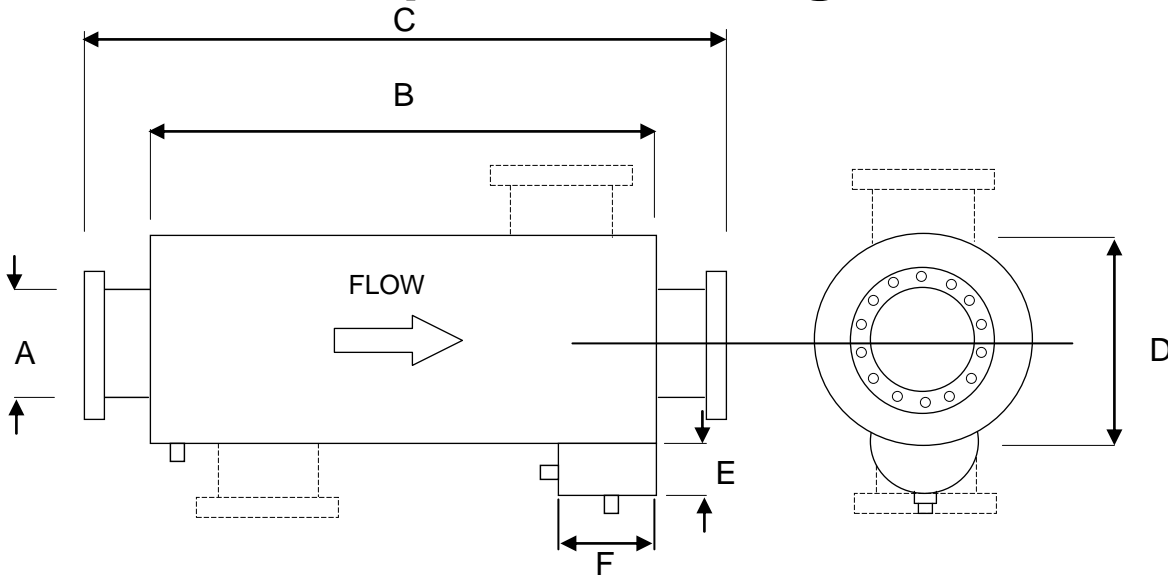

SG02/00262

SG02/55341

Residential Spark Arresting Silencers



SRE/SA

(END INLET-END OUTLET)

SRS/SA

(SIDE INLET-END OUTLET)

ØA	B	C	ØD	RAD E	F
75	1070	1240	350	65	175
100	1140	1315	400	75	225
125	1400	1575	450	75	250
150	1525	1705	550	90	275
200	1830	2040	660	100	300
250	2340	2555	760	150	375
300	2740	2955	915	150	450
350	3300	3560	1020	155	510
400	3860	4035	1170	160	575

* Larger sizes available on request

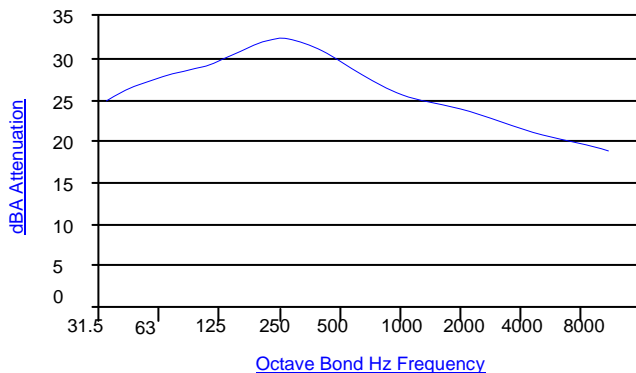

APPLICATION

Residential Spark Arresting series is a high performance reactive silencer recommended for those conditions where the ambient noise level in the environment is very low, particularly where stringent noise criterion is demanded and offers excellent broadband attenuation. For use with two and four cycle engines.

PERFORMANCE

An attenuation of up to 30dbA is attained from the outlet of SRE/SA range of silencers under open-field conditions.

FEATURES

- Mild steel body with JIS 5K flanges
- Coated with heat-resistant aluminum paint (Up to 600°C)
- Can be mounted either vertically or horizontally without affecting performance
- Modifications and other sizes available upon request

EXHAUST CONTROL INDUSTRIES (S) PTE LTD

69 TECH PARK CRESCENT, SINGAPORE 638073.

TEL NO : 67442689 FAX NO : 67472217 E-MAIL : enquires@eci.com.sg WEBSITE : www.eci.com.sg

* ECI is protected by local and international trademark legislations. Patent Pending.