

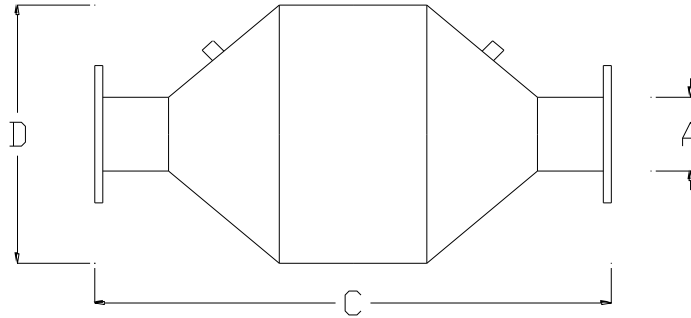

SG02/00262

SG02/55341

Catalytic Converter



ECW

(Flange End or Slot End)

Model	A	C	ØD
ECW 20	To Advise	840	495
ECW 22	To Advise	840	550
ECW 24	To Advise	890	600
ECW 25	To Advise	910	618
ECW 27	To Advise	990	655
ECW 29	To Advise	1020	698
ECW 30	To Advise	1040	725
ECW 32	To Advise	1090	770

*Other sizes available upon request

CONSTRUCTION:

The purifier housing is constructed from heavy gauge, high T304 stainless steel for corrosion resistance and long life. The catalyst substrate is also constructed from stainless steel and formed into a honeycomb like structure. The robust construction of the housing and catalyst substrate protects the unit against vibration, thermal stress and shock impacts which are associated with urban transport equipment.

PERFORMANCE FOR CATALYTIC CONVERTER:

This is a single-layered Purifier and can achieve maximum oxidation of black smoke under optimum temperature, as specified in the Productivity Standard Board (Singapore) Test Report Ref. No. Project: 2599209 dated September 1999, basing on British Standards 3405 (1983).

PERFORMANCE (BASED ON FULL LOAD):

Carbon Monoxide	*reduced by up to 90%
Hydrocarbons	*reduced by up to 90%
Particulates	*reduced by up to 25-30%
Soluble Organic Fraction	*reduced by up to 85%

* Under optimal thermal and operating conditions.

CHEMICAL REACTION:

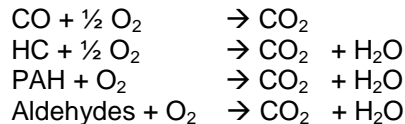

A coated catalyst block is expected to perform for 5 years or more. It is self-regenerating or cleaning when the engine is operating at an exhaust gas temperature of 360°C and above for a few hours continuously.

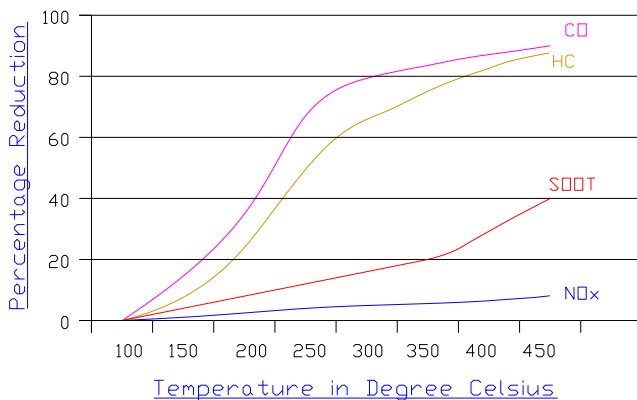

EXHAUST CONTROL INDUSTRIES (S) PTE LTD

69 TECH PARK CRESCENT, SINGAPORE 638073.

TEL NO : +65 6744 2689 FAX NO : +65 6747 2217 E-MAIL : enquires@eci.com.sg WEBSITE : www.eci.com.sg

* ECI is protected by local and international trademark legislations. Patent Pending.